

Scheme Details

Working with
Suffolk Highways
 your roads, our business

Type of Works: Bridge Repair
 Contractor Ref: TM -TBC
 Location: Rumsey Arch, B1116 Fressingfield

Drawing Number:
 PGT.M.PH.0761.001

Notes

- Traffic sign and orientation
- Road cone
- Closed road
- Diversion route
- Unsuitable diversion route*

Unsuitable Diversion Route

* Additional signs to be placed either end of unsuitable diversion routes.

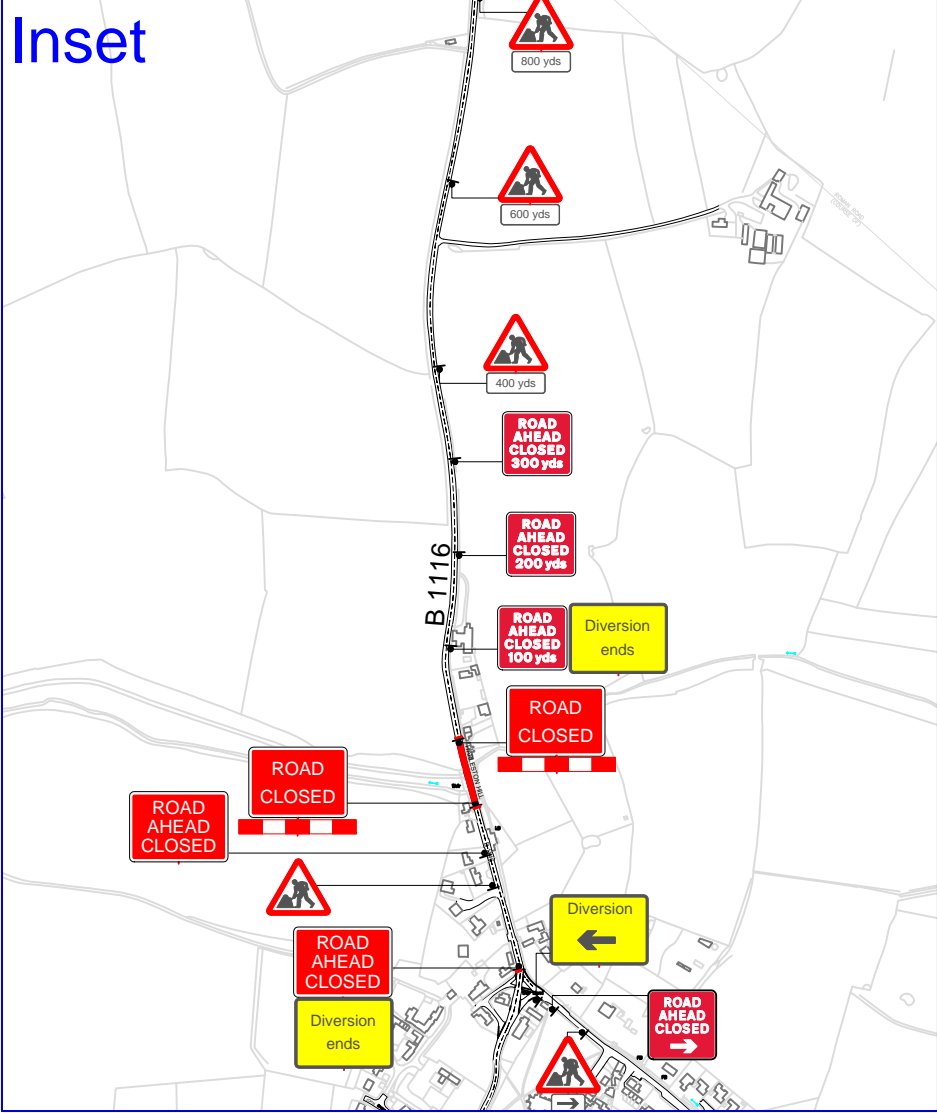

	DRN	CKD	APPD	REV	REV No'
By	PH	OR	JB		
Date	27/02/18	27/02/18	06/03/18		

Drawing Scale: NTS

This drawing remains the property of The Palmer Group (trading as Palmer Fencing) and may not be used in whole or in part for anything other than its intended purpose.

All traffic management must comply with the regulations as set out in 'Safety at Street Works and Road Works, A Code of Practice' and the 'Traffic Signs Manual, Chapter 8'